

Read carefully before assembling

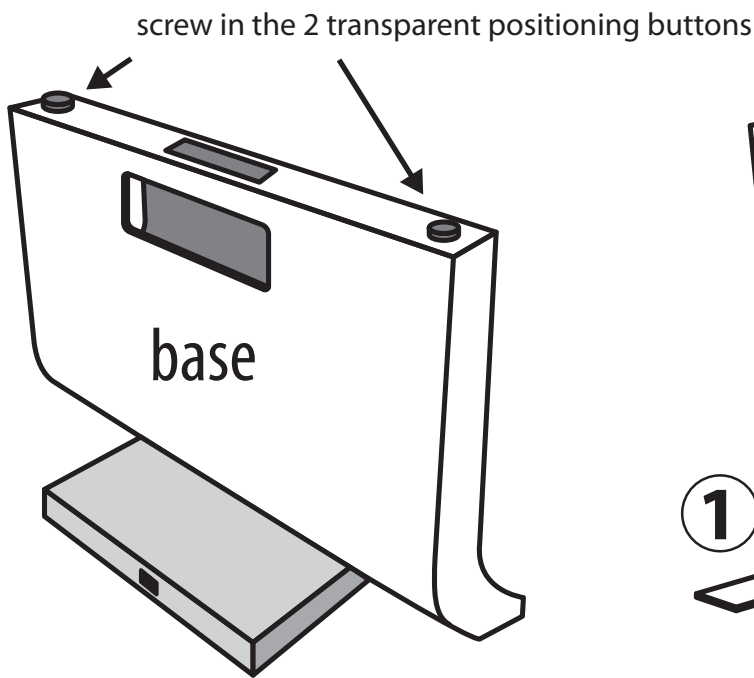

Lift the base off the pallet.

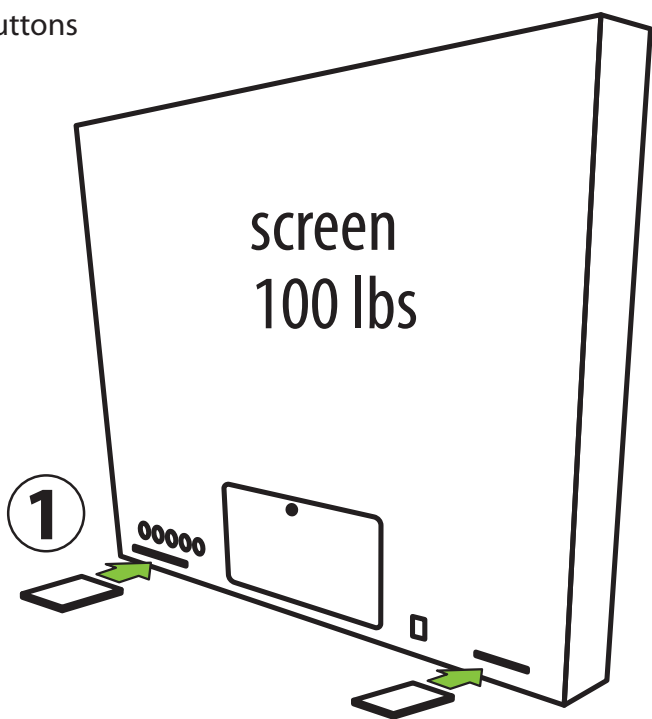

Insert the 2 white gripping plates (kit provided).

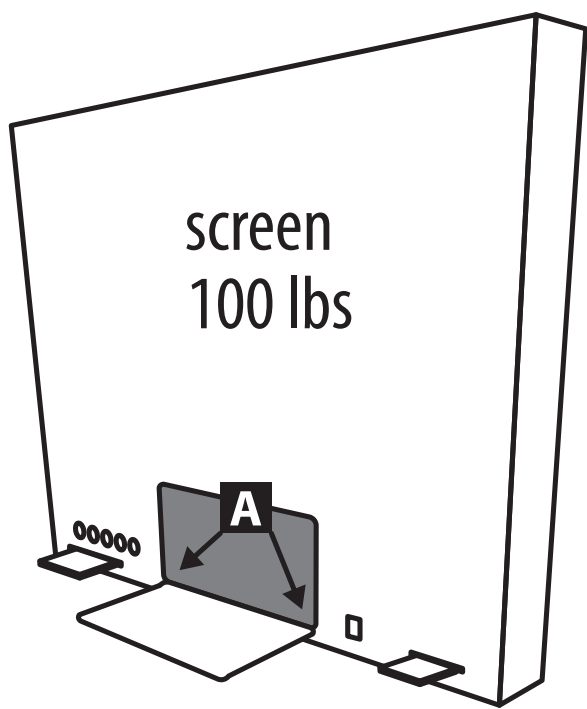

Open the hatch at the back of the screen to unscrew the 2 attachment screws (marker A).

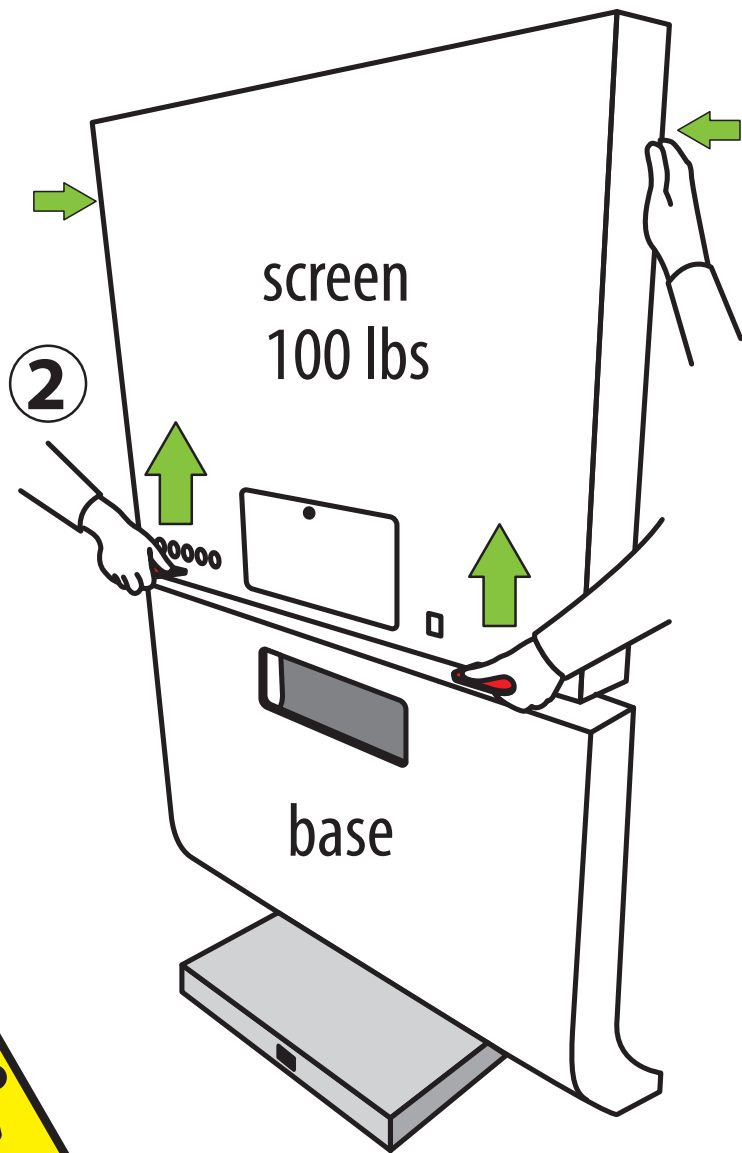

2/ Lift the screen (requires 2 people), remember to bend the legs to prevent back injuries. Careful, the screen weighs 100 lbs). Immobilize the base using your feet to prevent it from rolling and place the screen on the 2 positioning buttons.

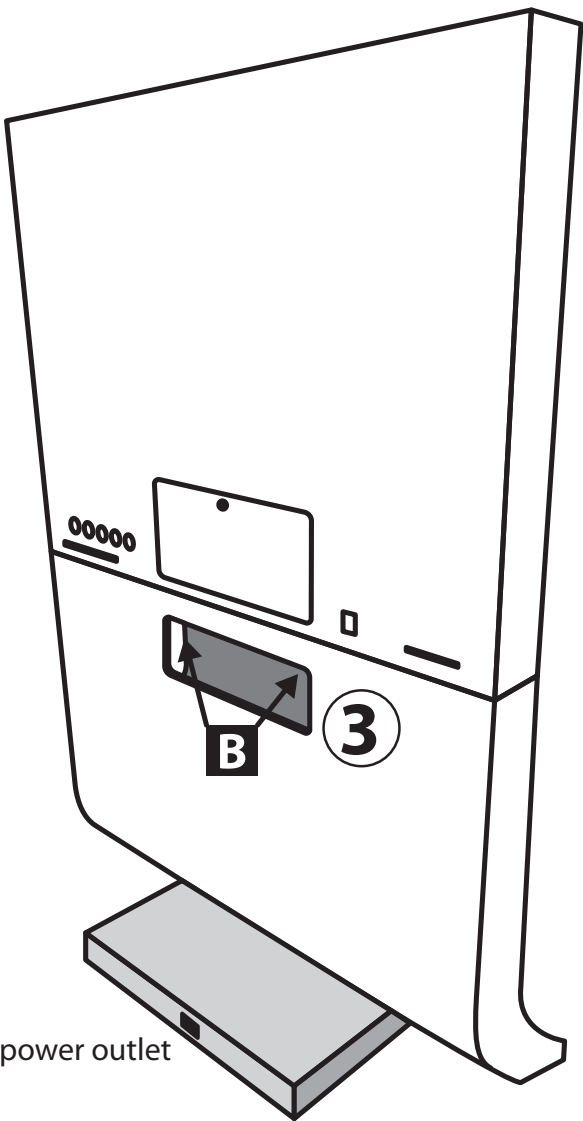

3 / Once placed the base, 1 person keeps the screen in place while the other screws in both attachment screws (marker B).



4 / Take the camera's wedge out.

5 / Open the hatch, take the cable located in the storage compartment and run it through the middle to plug it in the power cable to the right of the hatch.